

- 1 Install the elevate cable into Port A of the receiver



- 2 **Note:** Placement of the elevate modem on the cab roof is vitally important to performance. User must extend the entire length of the cable away from the receiver as shown below.



- 3 Select the Wrench > GPS/GNSS > GPS/GNSS Setup  
Select RTK as the correction source

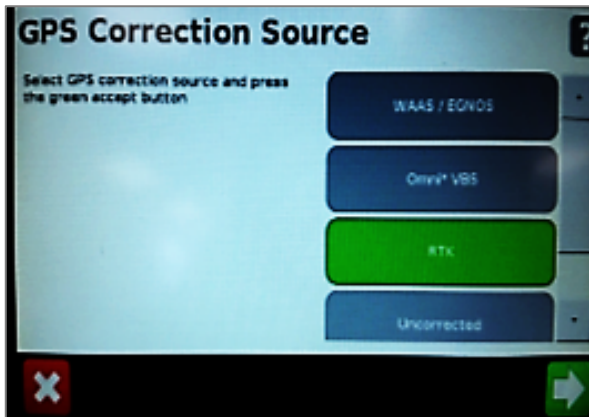

- 4 Select Generic RTCM3 Radio

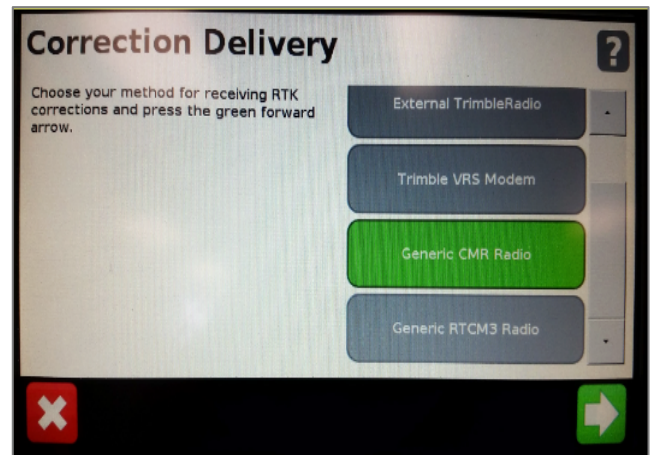

- 5 Select Favor Accuracy

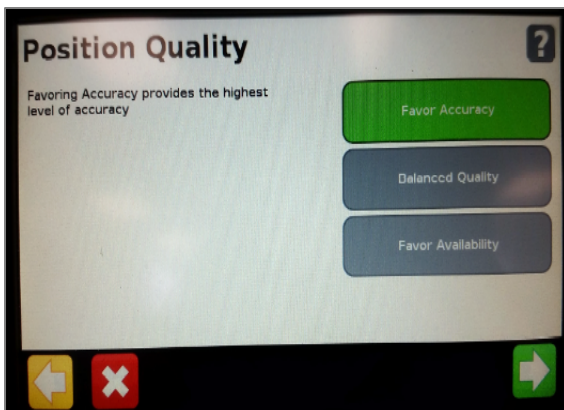

- 6 Confirm Baud rate = 38400,  
Data Parity = None & Stop bits = 1

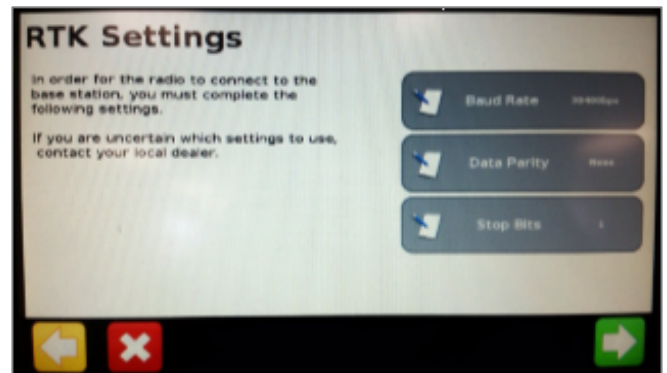

- 7 Select yes to use xFill, then go to the RTK Base Datum page

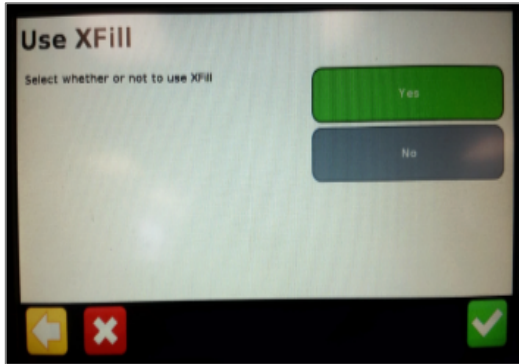

- 8 Select NAD83 as the Datum Type

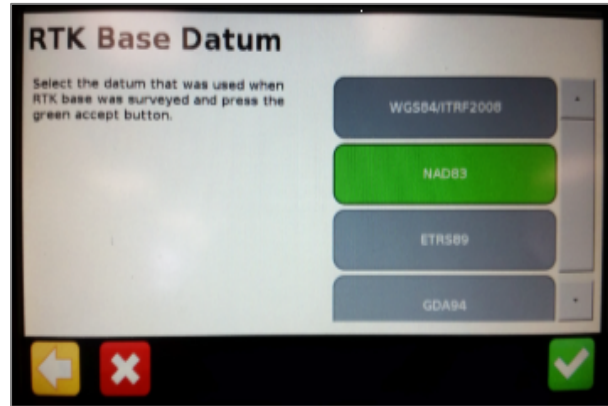

- 9 Return to the General Settings menu> System> Advanced> enable the Advanced User config > enter Advanced User config > Advanced Port setup

Confirm the port that the Beacon is physically connected to is setup as shown to the right.

Confirm RTK by returning to the mapping screen and confirming a green satellite icon in the top left corner.

### Serial Port A

